



Home Connect - Amazon Alexa



Amazon Alexa is a voice service which brings hands-free living to your home, letting you control your Home Connect appliances using your voice.

To use voice control with an Amazon Alexa device, you need to **download a 'skill'** for each appliance category within the Amazon Alexa app. Example skills available include: Home Connect Oven and Home Connect Coffee Machine. Please see page five of this document for instructions on how to download each 'skill'.

You are able to use commands through voice, including turning the appliance on and stopping the appliances. You can find examples of these commands on pages two - four of this document.



Amazon Alexa - Oven Commands

Commands help a user control their Home Connect appliance using their voice.
"Alexa" must be said before each command.

Configure *Alexa, tell my oven* to start hot air at 180 degrees for 45 minutes with fast preheat*

to (start / turn on / run) {Program} with {Intensity} for {Duration} with fast preheat

{Program}: **Bottom Heating / Desiccation / Dough Proving / Grill Large Area / Grill Small Area / Hot Air / Hot Air Eco / Hot Air Grilling / Intensive Heat / Keep Warm / Microwave / Pizza Setting / Reheat / Slow Cook / Top Bottom Heating / Top Bottom Heating Eco /**

Bake / Broil / Roast / Convection Broil / Warm / Pizza / True Convection / Dehydrate*

{Intensity}: **Temperature (Degrees Celsius/Fahrenheit) / Watt Level (Watt) / Grill Level (1,2,3)**

{Duration}: min. 1 min - max. 23 h

* If supported by appliance. Brand specific naming is supported as well.

Modify *Alexa, ask my oven* to set the temperature to 220 degrees*

Temperature set / switch / change the temperature / the power to {Intensity} (degrees / Watts)
add / raise / increase the temperature / the power to / by {Intensity} (degrees / Watts)
decrease / reduce the temperature / the power to / by {Intensity} (degrees / Watts)

Modify *Alexa, tell my oven* to increase the duration by 15 minutes*

Duration use / set / choose / change (a / the) (remaining) duration of / to {Duration}
increase / extend / reduce / decrease (the) (duration) by {Duration}

Modify *Alexa, tell my oven* to switch the program to hot air*

Program switch / use / choose / change (the heating mode / the program) to {Program}

Status *Alexa, ask my oven* what is the current status*

General Status give me / I want / what about (the / a) status / briefing / overview

Status *Alexa, ask my oven* when it will be ready*

Remaining Time to tell me the remaining time / duration
how much time is left
when my food / dish / dinner will be finished / done / ready

Status *Alexa, ask my oven* about its temperature*

Temperature about / for / what is the / its temperature / grill level / watt level

Confirm Prog. End *Alexa, tell my oven* to be quiet*

be silent / be quiet / shut up

Turn off *Alexa, ask my oven* to turn off*

power / turn / switch / shut (it) off
it should switch / turn off

Stop *Alexa, tell my oven* to stop the running program*

end / finish / stop (the) (running / active) (program / dish / microwave)



Amazon Alexa - Coffee Machine Commands

Commands help a user control their Home Connect appliance using their voice. "Alexa" must be said before each command.

Configure Program | *Alexa, tell my coffee machine to prepare a large, strong Espresso*

Alexa, **ask / tell** my coffee machine... to make a / to prepare a / I want a /
{Fill Quantity}, {Bean Amount}, {Program} /
{Bean Amount}, {Fill Quantity}, {Program}, /
{Program}, {Fill Quantity} and {Bean Amount}

{program} Ristretto, Espresso, Espresso Macchiato, Espresso Doppio, Coffee, Cappuccino, Latte Macchiato, Caffe Latte, Hot Water, Milk Froth, Warm Milk, Flat White, Americano, Ristretto, Cafe con Leche, Coffee Pot, Wiener Melange, Red Eye, Cafe au Lait, Cortado, Galão, Doppio, Kaapi, Grosser Brauner, Kleiner Brauner, Dead Eye, Cafe Cortado, Koffie Verkeerd, Verleangerter, Black Eye, Verlaengerter Braun, Garoto, Coffee XL

{Bean Amount} (optional) very mild, mild, normal, strong, very strong, double shot, double shot plus, double shot plus plus
more options, if supported by appliance: mild plus, normal plus, strong plus, very strong plus, extra strong, triple shot, triple shot plus

{Fill Quantity} (optional) small, medium, large

Abort | *Alexa, tell my coffee machine to cancel the program*

Alexa, **tell** my coffee machine (to) ... stop the program / cancel program / abort program

Status | *Alexa, ask my coffee machine for status*

Alexa, **tell** my coffee machine (to) ... give me the (current) status / I want to hear a quick briefing / give me an overview
Alexa, **ask** my coffee machine (for / about) ... the (current) status / what is the status / the overview

Turn On Appliance | *Alexa, tell my coffee machine to turn on*

Alexa, **tell** my coffee machine ... to switch on / to turn on / it should turn on

Turn Off Appliance | *Alexa, tell my coffee machine to switch off*

Alexa, **tell** my coffee machine ... to turn off / to switch off / shut down

Cleaning Status | *Alexa, ask my coffee machine when I should clean it*

Alexa, **ask** my coffee machine... when I should clean it / when it needs to be cleaned / if I should descale it



Amazon Alexa - Dishwasher Commands

Commands help a user control their Home Connect appliance using their voice.
"Alexa" must be said before each command.

Get Status | *Alexa, ask my dishwasher when my dishes will be ready*

Alexa, ask my dishwasher... for the status / when the dishes will be ready / how much time is left

Turn On | *Alexa, tell my dishwasher to turn on*

Alexa, ask / tell my dishwasher... to turn on / to power on

Turn Off | *Alexa, tell my dishwasher to turn off*

Alexa, ask / tell my dishwasher... to turn off / to power off / to shut off

Reset | *Alexa, tell my dishwasher to reset the current program*

Alexa, ask / tell my dishwasher... to reset / stop the current program / {program}

Enable Notifications | *Alexa, tell my dishwasher to turn on notifications*

Alexa, ask / tell my dishwasher... to enable / allow / turn on notifications

Disable Notifications | *Alexa, tell my dishwasher to turn off notifications*

Alexa, ask / tell my dishwasher... to disable / not allow / turn off notifications

Configure Program | *Alexa, tell my dishwasher to start Normal 45 degrees, vario speed*

Alexa, ask / tell my dishwasher... to start / to run / to set / {program} with / and {option} / {option} with / and {option}

{program} Favourite / Auto 35 to 45 degrees / Auto 45 to 65 degrees / Auto 65 to 75 degrees / Half load / Eco 50 / Express Sparkle / Glass 40 / Glass Care / Intensive 45 / Intensive 70 / Chef 70 / Short 60 / Machine Care / Magic Daily / Maximum Cleaning / Mixed Load / Silence / Normal 45 / Normal 65 / Pre Rinse / Quick Wash 45 / Quick Wash 65 / Steam Fresh / Super 60 / Turbo Speed

{option} Delicate Basket / Energy Save / Extra Dry / Extra Rinse / Half Load / Holiday Mode / Hygiene Plus / Intensive Zone / Sanitation UC / Storage Function / Vario Speed Plus / Zeo Dry / Brilliance Dry / Eco Dry

*if supported by appliance; program and option names may vary

Set Delay | *Alexa, tell my dishwasher to start in 2 hours*

Alexa, ask / tell my dishwasher... to start / to run in {relative time} at {absolute time}

Start | *Alexa, tell my dishwasher to start*

Alexa, ask / tell my dishwasher... to start / to run



How to set up Amazon Alexa with your Home Connect Appliance

To get started on your smartphone or tablet, download the **Amazon Alexa app** and create an account. Next, ensure your **Home Connect app** is connected to your appliances. Then follow the below steps to connect the Amazon Alexa app to your Home Connect appliance.

1. Open the Amazon Alexa app. Click 'More' then 'Skills & Games'.

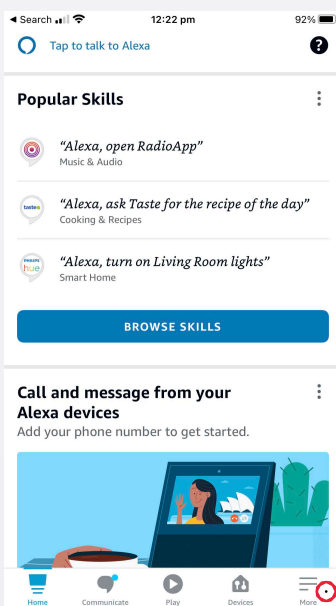

2. Search 'Home Connect'.

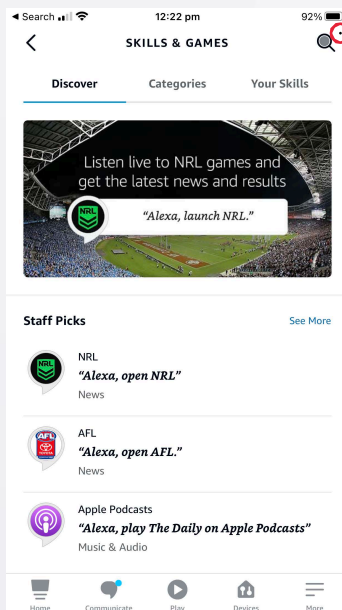

3. Select the 'skills' you'd like to use. You need to download a 'skill' for each appliance category. Example skills: Home Connect Oven, Home Connect Coffee Machine.

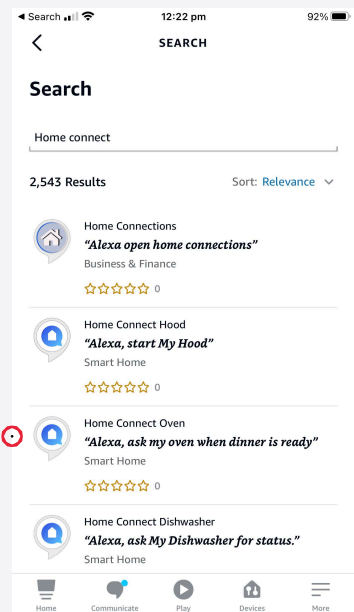

4. Select 'Enable to use'.

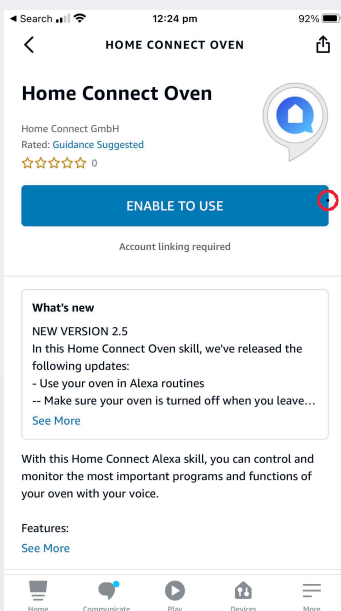

5. Login to your 'Home Connect' account.

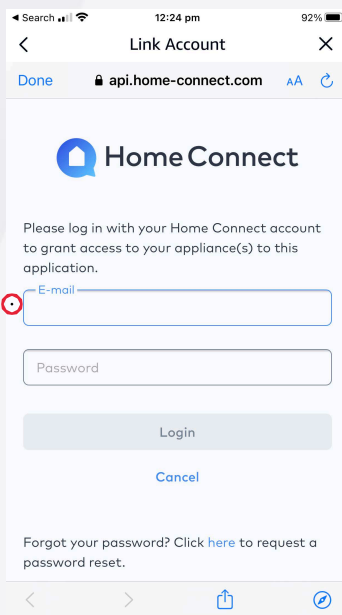

6. Select 'Approve' and you are ready to go!

