

# Your washing machine

**Congratulations** – You have opted for a modern, high-quality domestic appliance manufactured by Neff. The washing machine is distinguished by its economical energy consumption.

Each appliance which leaves our factory is inspected thoroughly to ensure that it functions properly and is in perfect condition.

For further information and a selection of our products go to our web site: <http://www.neff.de> or contact our customer service centres

## Environmental disposal

Dispose of packaging in an environmentally friendly manner.

This appliance has been identified in accordance with the European Directive 2002/96/EG on Waste Electrical and Electronic Equipment (WEEE).

The Directive specifies the framework for an EU-wide valid return and recycling of waste appliances.

## Contents

Page

■ Intended use	1
■ Programmes	1
■ Setting programme	3
■ Washing	3/4
■ After washing	4
■ Individual settings	5
■ Important information	6
■ Overview of programmes	7
■ Safety instructions	8
■ Consumption values	8
■ Care	9
■ Information on the display panel	9
■ Maintenance	10
■ What to do if ...	11

## Intended use

- for use in the household only,
- for the washing of machine-washable textiles in a detergent solution,
- to be operated with cold drinking water and commercially available detergents and care products which are suitable for use in washing machines.

- ⚠ Do not leave children unattended near the washing machine!
- Keep pets away from the washing machine!



Dispose of packaging in an environmentally friendly manner.

This appliance has been identified in accordance with the European Directive 2002/96/EG on Waste Electrical and Electronic Equipment (WEEE).

The Directive specifies the framework for an EU-wide valid return and recycling of waste appliances.

## Preparation

⚠ **Correct installation according to separate installation instructions.**

### Checking the machine

- Never switch on a damaged machine!
- Inform your customer service!

### Turn on the tap

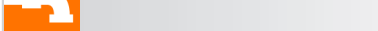

– Do not leave children unattended near the washing machine!

### Insert mains plug

- ⚠ **With dry hands only! Take hold of the plug only!**

### Sorting and inserting the washing

Follow manufacturer's care information! According to the information on the care labels. According to type, colour, soiling and temperature. Do not exceed maximum load → page 7.

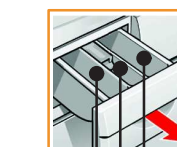

- Dispenser I: Detergent for prewash
- Dispenser II: Detergent for main wash, fabric softener, bleaching agent, stain remover
- Dispenser III: Fabric softener, starch

### Add detergent and care product

Washing amount, soiling, water hardness (ask your water supply company) and manufacturer's instructions. Pour liquid detergent into the appropriate dispenser and place in the drum.

Meter accordingly: Dilute viscous fabric softener and fabric conditioner with water. Prevents blockage.

## Set and adjust programme

For additional functions and option buttons see individual settings, → page 5.

ⓘ All buttons are sensitive, they only need to be touched gently! If the Option buttons are touched for longer, the setting options will automatically run!

ⓘ Programme selector for switching the machine on and off and for selecting the programme. Can be rotated in either direction.

### Select Start/Pause

# Wash

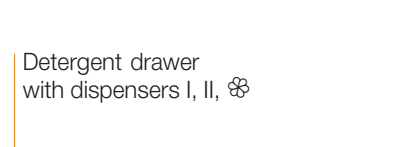

1

2

3

Wash

## Removing washing

Open washing machine door and remove washing. If Rinse hold = without final spin) active: Set programme selector to **Empty** or select spin speed. Select **Start/Pause**. Remove any foreign objects – risk of rusting.

### Turn off the tap

Not required for Aqua-Stop models.

### Switch off

Set programme selector to **Off**.

### End of programme when ...

... **Start/Pause** flashes and **-0-** is indicated on the display panel.

### Change programme ...

If you have mistakenly selected a wrong programme:  
– Reselect programme.  
– Select **Start/Pause**.

### ... or terminate

Programmes with high temperature, first:  
– Cool washing: Select **Rinse**.  
– Washing machine door remains locked.  
– Select **Off**.  
– Select **Spin** or **Empty**.  
– Select **Start/Pause**.

## Individual settings

### Option buttons

You can change the spin speed and temperature beforehand and while the selected programme is running. Effects dependent on the programme progress.

#### (temperature °C)

You can change the indicated washing temperature. The maximum washing temperature which can be selected depends on the set programme.

#### (ready in)

The respective programme duration is displayed by selecting the programme. The programme start can be delayed before the programme begins. The (ready in)-time can be set in hour-steps up to maximum 24h. Keep pressing the (ready in) button until the required number of hours is indicated (h=hour). Select **Start/Pause**.

#### (rpm)

You can change the indicated spin speed. The maximum spin speed which can be selected depends on the set programme.

### Additional functions

Intensive	Extension of the washing time for a more intensive washing of highly soiled washing or 7 kg of cottons and coloureds.
(Prewash)	For heavily soiled, hard-wearing washing, e.g. made of cotton or linen. Prewash at 30 °C.
(Easy iron)	Special spin sequence with subsequent fluffing. Gentle final spin – residual moisture in the washing increased slightly.
(Water plus)	Increased water level and additional rinse cycle, extended washing time. For areas with very soft water or for further improvement of the rinsing result.

### Start/Pause

For starting or interrupting the programme.

### Signal

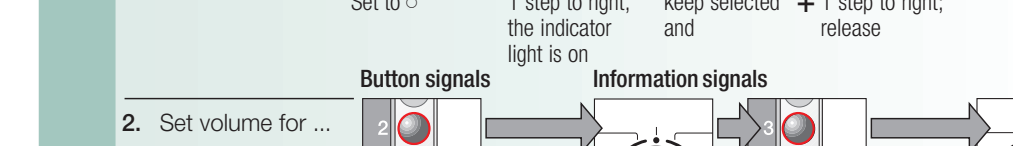
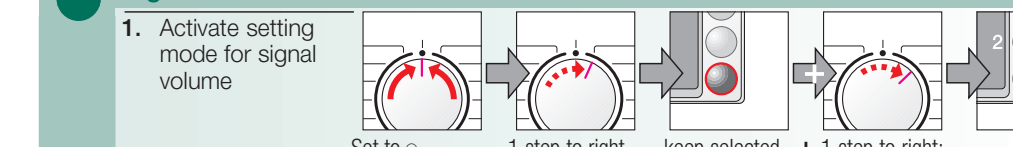

\* If required, select repeatedly

## Important information

### Protecting the washing and the machine

- Empty pockets.
- Remove metal parts (paper clips, etc.).
- Wash delicates in the net/bag (tights, curtains, underwired bras).
- Close zips, button up covers.
- Brush sand out of pockets and collars.
- Remove curtain fittings or include in the net/bag.

### Before washing for the first time

Do not put any washing in the washing machine! Turn on the tap, fill approx. 1 litre of water and then pour ½ measuring cup of detergent into dispenser II. Set programme selector to **Synthetics** 60 °C and select **Start/Pause**. At the end of the programme set the programme selector to **Off**.

### Washing with different degrees of soiling

Light	Wash new items separately. Do not prewash.
Medium	If required, pretreat stains. Select Intensive additional function.
Heavy	Load less washing. Prewash.

### Soaking

Load washing of the same colour. Pour soaking agent/detergent into dispenser II according to the manufacturer's instructions. Set programme selector to **Cottons** 30 °C and select **Start/Pause**. After approx. 10 minutes select **Start/Pause**. After the required soaking time reselect **Start/Pause** if the programme is to be continued or change the programme.

### Starching

Washing should not be treated with fabric softener. Liquid starch can be used in all wash programmes. Meter starch into the fabric softener dispenser according to manufacturer's specifications.

### Dyeing/Bleaching

Dye in small quantities only. Salt can corrode stainless steel. Observe the dye manufacturer's specifications. Do not bleach laundry in the washing machine.

### Protection of the environment/conservation tips

- Utilise the maximum amount of washing for the particular programme.
- Wash normally soiled washing without prewash.
- Instead of **Cottons** 90 °C select **Eco** 60 °C programme. Comparable cleaning result with significantly lower energy consumption.
- Meter detergent according to the manufacturer's instructions and water hardness.
- If the washing is then dried in the tumble dryer, select spin speed according to the instructions of the dryer manufacturer.

(Intensive), (Prewash), (Easy iron), (Water plus); for particularly sensitive skin, prolonged washing at selected temperature, higher water level, additional rinse cycle

(Intensive), (Prewash), (Easy iron), (Water plus)

(Intensive), (Prewash), (Easy iron), (Water plus); Different types of washing can be washed together

(Intensive), (Prewash), (Easy iron), (Water plus); reduced rinse and final spin cycle

(Intensive), (Prewash), (Easy iron), (Water plus); no spin cycle between the rinse cycles

Especially gentle wash programme to prevent shrinkage, prolonged programme pauses (textiles rest in the detergent solution).

(Intensive), (Prewash), (Easy iron), (Water plus)

Short programme approx. 15 minutes suitable for lightly soiled laundry

Rinse, Spin, Empty, Gentle Spin

The programmes are time-controlled for lightly soiled textiles. If textiles are heavily soiled, select additional function (Intensive). When washing the maximum load for programmes marked with "i", always select the (Intensive) option. Regardless of the type of washing, Synthetics 40 °C with maximum spin speed is the best short programme for the job. Programmes without prewash - pour detergent into dispenser II, programmes with prewash - divide detergent between dispensers I and II.

Neff GmbH  
Carl-Wery-Str. 34  
81739 München / Germany

W7320FDEU / ...

8808  
9000 249 350

## Consumption values

Programme	Additional function	Load	Current **	Water **	Programme duration **
Cottons 40 °C*	(Intensive)	7 kg	0.65 kWh	60 l	2:30 h
Eco 60 °C*	(Intensive)	7 kg	1.19 kWh	49 l	2:36 h
Cottons 90 °C	(Intensive)	7 kg	2.00 kWh	75 l	2:33 h
Synthetics 40 °C*	(Intensive)	3 kg	0.55 kWh	50 l	1:24 h
Synthetics 40 °C* (also suitable as short programme)	-	3 kg	0.54 kWh	40 l	0:55 h
Mix 30 °C	-	3 kg	0.32 kWh	35 l	0:44 h
Silk 30 °C	-	2 kg	0.25 kWh	38 l	0:32 h
Wool 30 °C*	-	2 kg	0.15 kWh	34 l	0:40 h

\* Programme setting to be tested in accordance with European standard 60 456.

Note on comparative tests: test the test programme with maximum load, (Intensive) option selected, maximum spin speed.

A short programme which can be used for coloured items is Synthetics 40 °C, without the (Intensive) option selected and set to maximum spin speed.

\*\* The values deviate from the indicated values depending on water pressure, water hardness, water inlet temperature, room temperature, type and amount of washing and degree of soiling, utilised detergent, fluctuations in the mains voltage and selected additional functions.

## Safety instructions

- Read and follow the operating and installation instructions and all other information enclosed with the washing machine.
- Retain documents for subsequent use.

**Risk of electric shock**

- Never pull out the mains plug by tugging the power cord!
- Never insert/pull out the mains plug with damp hands.

**Risk of injury**

- Washing machine door may become very hot.
- Caution when draining hot detergent solution.
- Do not climb on the washing machine.
- Do not lean on the open washing machine door.
- Do not touch the drum in case it is still spinning.
- Caution when opening the detergent drawer while washing machine is running!
- Keep detergents and care products out of the reach of children.
- Keep packaging, plastic film and packaging parts out of the reach of children.

**Danger to life**

- On redundant appliances:
  - Pull out the mains plug.
  - Sever the power cord and discard together with the plug.
  - Destroy the lock on the washing machine door. This will prevent children from locking themselves in and suffocating.
- Caused by detergents containing solvents, e.g. stain remover/items of washing pretreated with solvent naphtha may result in an explosion after being loaded into the washing machine. Beforehand thoroughly rinse items of washing by hand.

**Risk of poisoning**

**Risk of suffocation**

**Risk of explosion**

## Care

### Machine housing, control panel

- Wipe with a soft, damp cloth.
- Do not use any abrasive cloths, sponges or cleaning agents (stainless-steel cleaner).
- Immediately remove washing and cleaning agent residue.
- Do not clean the appliance with a water jet.

### Clean the detergent drawer ...

... if it contains detergent or fabric softener residue.

1. Pull out, depress insert, completely remove.
2. Open the cover.
3. Clean with water and dry.
4. Close and lock the cover (place cylinder on guide pin).
5. Insert detergent drawer.

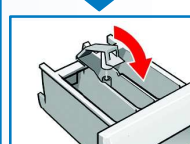
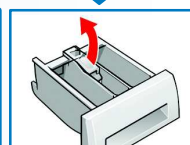
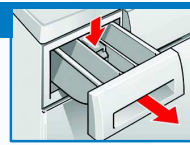

Leave detergent drawer open so that residual water can evaporate.

### Drum

Leave washing machine door open so that the drum can dry out. Rust stains - use chlorine-free cleaning agent, not steel wool.

### Descaling No washing in the machine!

Descal according to the instructions of the descaling agent-manufacturer, not required for correct detergent dosage.

## Information on the display panel

depending on model

F:16	Close the washing machine door properly; washing may be caught.
F:17	Turn the tap on fully, supply hose kinked/jammed; clean filter -> page 10, water pressure too low.
F:18	Filter blocked; clean detergent solution pump -> Page 10.
F:21	Motor fault. Call customer service!
F:23	Water in the base pan, appliance leaking. Call customer service!

## Maintenance

### Detergent-solution pump

Set programme selector to **Off**, pull out the mains plug.

1. Open and remove service flap.

For models with drainage hose:  
Take drainage hose out of the holder and pull out of the housing. Remove sealing cap, allow detergent solution to flow out. Press on sealing cap and insert drainage hose into the holder.

For models without drainage hose:  
Carefully unscrew pump cover until the detergent solution begins to run out. When the service flap is half full, screw back the pump cover and empty the service flap. Repeat steps until all the detergent solution has run out.

3. Carefully unscrew the pump cover (residual water).
4. Clean the interior, pump cover thread and pump housing (fan impeller in the detergent-solution pump must rotate).

5. Reinsert and screw on pump cover.
6. Insert and close service flap.

To prevent unused detergent from flowing into the outlet during the next wash: Pour 1 litre of water into dispenser II and select the **Empty** programme.

### Drainage hose on the siphon

Set programme selector to **Off**, pull out the mains plug.

1. Loosen hose clip, carefully remove drainage hose (residual water).
2. Clean drainage hose and siphon spigot.
3. Re-attach drainage hose and secure connection point with hose clip.

### Filters in the water supply

**Risk of electric shock!** Do not immerse Aqua-Stop safety device in water (contains electric valve).

Release water pressure in the supply hose:

1. Turn off the tap!
2. Select any programme (except Spin/Empty).
3. Press Start/Pause. Leave programme for approx. 40 seconds.
4. Set programme selector to **Off**.
5. Remove hose from tap.
6. Clean filter with small brush.
7. Depending on the model, remove hose from the rear of the appliance and clean the filter.

8. Connect the hose and check for leaks.



- Risk of scalding!
- Allow detergent solution to cool down!
- Turn off the tap!

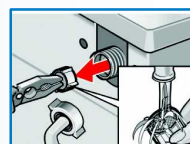
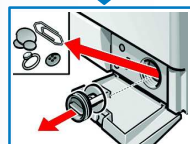
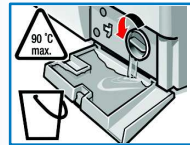
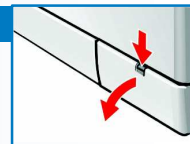

## What to do if ...

- Water is running out.
  - Correctly attach/replace drainage hose.
  - Tighten screw-fitting on the supply hose.
- Water not flowing in. Detergent not washed in.
  - Start/Pause not selected?
  - Tap not open?
  - Filter blocked? Clean filter -> page 10.
  - Supply hose kinked or jammed?
- Washing machine door cannot be opened.
  - Safety function active. Wait approx. 2 minutes.
  - (Rinse hold = without final spin) selected?
- Programme does not start.
  - Start/Pause selected?
  - Door closed?
- Detergent solution is not drained.
  - Clean detergent-solution pump -> page 10.
  - Clean outlet pipe and/or drainage hose.
- Washing not spun correctly.
  - Distribute small and large items of washing in the drum.
- Spin cycle actuated several times.
  - Not a fault - unbalanced load detection system adjusts imbalance.
- Water not visible in the drum.
  - Not a fault - water below the visible area.
- Residual water in the dispenser for care product.
  - Not a fault - effect of the care product not impaired.
- Odour formation in the washing machine.
  - Run Cottons 90 °C programme without washing. Use standard detergent.
- Foam is coming out of the detergent drawer.
  - Too much detergent used?
  - If detergent comes out of the detergent drawer: mix 1 tablespoon of fabric softener with 1/2 litre of water and pour into dispenser II (not for outdoor textiles!).
  - Reduce detergent dosage for the next wash cycle.
- Vibrations during spin cycle.
  - Appliance feet fixed?
  - Secure appliance feet -> Installation instructions.
  - Transportation safety devices removed?
  - Remove transportation safety devices -> Installation instructions.
- Spin result not satisfactory.
  - (Easy iron) selected? -> page 5.
- Display panel/indicator lights do not function while the appliance is running.
  - Power failure?
  - Fuse tripped? Switch on/replace fuse.
  - If the fault occurs repeatedly, call customer service.
- Programme progress longer than usual.
  - Not a fault - unbalanced load detection system adjusts imbalance by repeatedly distributing the washing.
  - Not a fault - Foam detection system active - a rinse cycle is started.
- Detergent residue on the washing.
  - Occasionally phosphate-free detergents contain water-insoluble residue.
  - Select Rinse or brush the laundry after washing.
- If a fault cannot be rectified or a repair is required:
  - Set programme selector to **Off** and pull out the mains plug.
  - Turn off the tap and call customer service -> Installation instructions.

## OPERATING INSTRUCTIONS

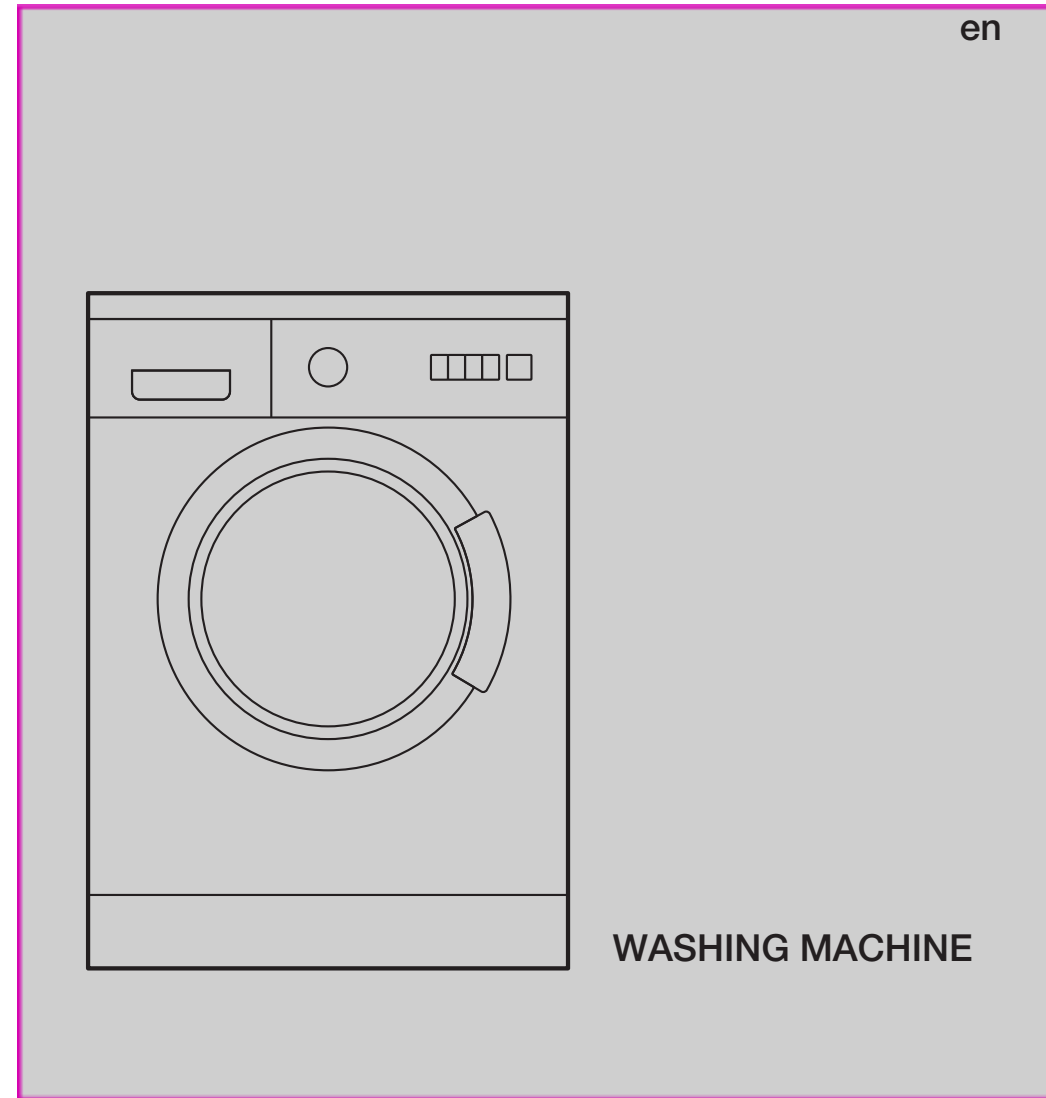

**Read these instructions before switching on the washing machine! Also follow the separate Installation instructions. Follow the safety instructions on page 8!**



# Your washing machine

**Congratulations** – You have opted for a modern, high-quality domestic appliance manufactured by Neff. The washing machine is distinguished by its economical energy consumption.

Each appliance which leaves our factory is inspected thoroughly to ensure that it functions properly and is in perfect condition.

For further information and a selection of our products go to our web site:

<http://www.neff.de> or contact our customer service centres

## Environmental disposal

Dispose of packaging in an environmentally friendly manner.

This appliance has been identified in accordance with the European Directive 2002/96/EG on Waste Electrical and Electronic Equipment (WEEE).

The Directive specifies the framework for an EU-wide valid return and recycling of waste appliances.



## Contents

Page

Intended use	1
Programmes	1
Setting programme	3
Washing	3/4
After washing	4
Individual settings	5
Important information	6
Overview of programmes	7
Safety instructions	8
Consumption values	8
Care	9
Information on the display panel	9
Maintenance	10
What to do if ...	11

## Intended use

- for use in the household only,
- for the washing of machine-washable textiles in a detergent solution,
- to be operated with cold drinking water and commercially available detergents and care products which are suitable for use in washing machines.

- Do not leave children unattended near the washing machine!
- Keep pets away from the washing machine!

## Preparation

Correct installation according to separate installation instructions.

### Checking the machine

- Never switch on a damaged machine!
- Inform your customer service!

### Turn on the tap

### Insert mains plug

- With dry hands only!
- Take hold of the plug only!



Dilute viscous fa

## Programmes

For detailed overview of programmes -> page 7.  
Temperature and spin speed can be selected individually.

Cottons	hard-wearing textiles
Intensive	} hard-wearing textiles
Eco e	
Sensitive	
Synthetics	easy-care textiles
Silk	delicate washable textiles
Wool	hand/machine-washable textiles
Empty	the rinsing water if occurs
Spin	washing washed by hand
Gentle Spin	washing washed by hand at reduced spin speed
Rinse	with subsequent spin cycle
Sports Wash	textiles made of microfibres
Super Quick	short programme
Mix	different types of washing
Synthetics+	dark textiles

⊛ - 90	↓ (temp. °C)	Select the temperature
1 - 24h	⌚ (ready in)	Programme ends in ...
∪ - 1200*	⊙ (rpm.)	Select the spin speed (∪ (Rinse hold = without spin))
<b>Status displays</b>		Programme progress
🧺	🧺	Washing, Rinse, Spin, ...

Before washing for the first time,  
wash once without any washing. -> page 6

## Sorting and inserting the washing

Follow manufacturer's care information!  
According to the information on the care labels.  
According to type, colour, soiling and temperature.  
Do not exceed maximum load -> page 7.

Follow important instructions! -> page 6!

Insert large and small items of washing! Close the washing machine door. Take care not to trap any items of clothing between the loading door and rubber seal.

## Add detergent and care product

Meter accordingly:  
Washing amount, soiling, water hardness (ask your water supply company) and manufacturer's instructions. Pour liquid detergent into the appropriate dispenser and place in the drum.

- Dispenser I:** Detergent for prewash
  - Dispenser ☼:** Fabric softener, starch
  - Dispenser II:** Detergent for main wash, fabric softener, bleaching agent, stain remover
- Fabric softener and fabric conditioner with water. Prevents blockage.*

## Set and adjust programme

For additional functions and option buttons see individual settings, -> page 5.

**i** All buttons are sensitive, they only need to be touched gently!  
If the Option buttons are touched for longer, the setting options will automatically run!

**i** Programme selector for switching the machine on and off and for selecting the programme. Can be rotated in either direction.

Select **Start/Pause** ◊

Programme selector

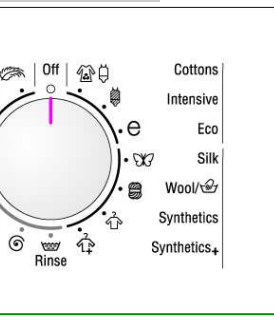

(☼ = cold)

\* depending on model) or  
at final spin)

displays:  
End

# Wash

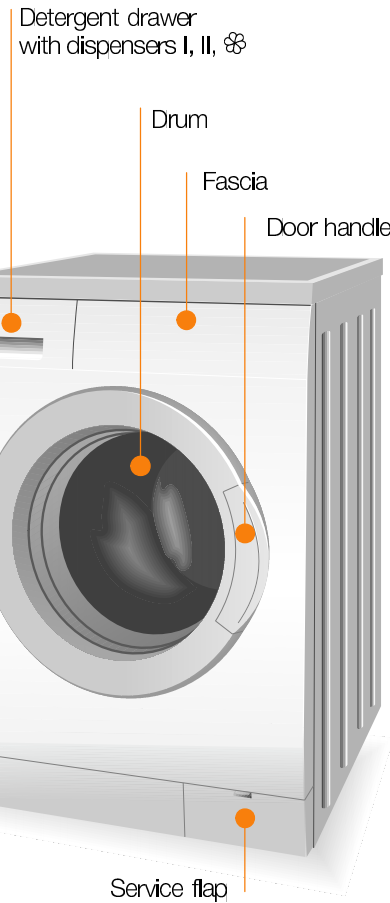

1

2

3

# Wash

## Removing washing



Open washing machine door and remove washing.  
If ☼ (Rinse hold = without final spin) active: Set programme selector to **Empty** ☼ or select spin speed. Select **Start/Pause** ◊.  
Remove any foreign objects – risk of rusting.



## Turn off the tap

Not required for Aqua-Stop models.



## Switch off

Set programme selector to **Off**.

## End of programme when ...

... **Start/Pause** ◊ flashes and **-0-** is indicated on the display panel.

## Change programme ...

If you have mistakenly selected a wrong programme:  
– Reselect programme.  
– Select **Start/Pause** ◊.

## ... or terminate

Programmes with high temperature, first:  
– Cool washing: Select **Rinse** ☼.  
Washing machine door remains locked.  
– Select **Off**.  
– Select **Spin** ☼ or **Empty** ☼.  
– Select **Start/Pause** ◊.

# Individual settings

## Option buttons

You can change the spin speed and temperature beforehand and while the selected programme is running. Effects dependent on the programme progress.

### 🌡️ (temperature °C)

You can change the indicated washing temperature. The maximum washing temperature which can be selected depends on the set programme.

### 🕒 (ready in)

The respective programme duration is displayed by selecting the programme. The programme start can be delayed before the programme begins. The 🕒 (ready in)-time can be set in hour-steps up to maximum 24h. Keep pressing the 🕒 (ready in) button until the required number of hours is indicated (h=hour). Select **Start/Pause** ◊.

### 🌀 (rpm)

You can change the indicated spin speed. The maximum spin speed which can be selected depends on the set programme.

## Additional functions *see also programme overview*

👕 (Intensive)	Extension of the washing time for a more intensive washing of highly soiled washing or 7 kg of cottons and coloureds.
👕 (Prewash)	For heavily soiled, hard-wearing washing, e.g. made of cotton or linen. Prewash at 30 °C.
👕 (Easy iron)	Special spin sequence with subsequent fluffing. Gentle final spin – residual moisture in the washing increased slightly.
👕 (Water plus)	Increased water level and additional rinse cycle, extended washing time. For areas with very soft water or for further improvement of the rinsing result.

## Start/Pause ◊

For starting or interrupting the programme.

## Signal

1. Activate setting mode for signal volume

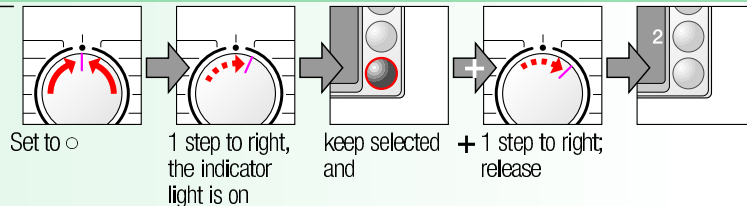

2. Set volume for ...

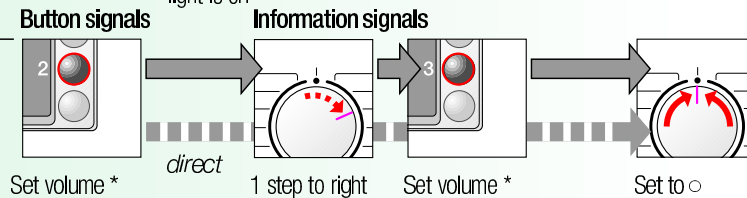

\* If required, select repeatedly

\* If required, select repeatedly



# Important information



## Protecting the washing and the machine

- Empty pockets.
- Remove metal parts (paper clips, etc.).
- Wash delicates in the net/bag (tights, curtains, underwired bras).
- Close zips, button up covers.
- Brush sand out of pockets and collars.
- Remove curtain fittings or include in the net/bag.



## Before washing for the first time

Do not put any washing in the washing machine! Turn on the tap, fill approx. 1 litre of water and then pour ½ measuring cup of detergent into dispenser II. Set programme selector to **Synthetics** 🌀 60 °C and select **Start/Pause** ◊.

At the end of the programme set the programme selector to **Off**.



## Washing with different degrees of soiling

Light		Wash new items separately. Do not prewash.
Heavy		If required, pretreat stains. Select 👕 (Intensive) additional function. Load less washing. Prewash.



## Soaking *Load washing of the same colour*

Pour soaking agent/detergent into dispenser II according to the manufacturer's instructions. Set programme selector to **Cottons** 🌀 30 °C and select **Start/Pause** ◊. After approx. 10 minutes select **Start/Pause** ◊. After the required soaking time reselect **Start/Pause** ◊ if the programme is to be continued or change the programme.



## Starching *Washing should not be treated with fabric softener*

Liquid starch can be used in all wash programmes. Meter starch into the fabric softener dispenser 🌀 according to manufacturer's specifications.



## Dyeing/Bleaching

Dye in small quantities only. Salt can corrode stainless steel. Observe the dye manufacturer's specifications. Do **not** bleach laundry in the washing machine.



## Protection of the environment/conservation tips

- Utilise the maximum amount of washing for the particular programme.
- Wash normally soiled washing without prewash.
- Instead of **Cottons** 🌀 90 °C select **Eco E** 60 °C programme. Comparable cleaning result with significantly lower energy consumption.
- Meter detergent according to the manufacturer's instructions and water hardness.
- If the washing is then dried in the tumble dryer, select spin speed according to the instructions of the dryer manufacturer.

# Programme overview -> Pay attention to the Consumption values table on page 8 and the information on page 6.

Programmes °C max. Type of washing



Additional functions; information

Programmes	°C	max.	Type of washing	Additional functions; information
Cottons	*-90 °C			
Intensive		7 kg*	Hard-wearing textiles, heat-resistant textiles made of cotton or linen	(Intensive),  (Prewash),  (Easy iron),  (Water plus)
Eco	*-60 °C			
Sensitive				(Intensive),  (Prewash),  (Easy iron),  (Water plus); for particularly sensitive skin, prolonged washing at selected temperature, higher water level, additional rinse cycle
Synthetics	*-60 °C		Easy-care textiles made of cotton, linen, synthetic fibres or blended fabrics	(Intensive),  (Prewash),  (Easy iron),  (Water plus); Different types of washing can be washed together
Mix	*-40 °C	3 kg*	Textiles made of cotton and easy-care textiles	(Intensive),  (Prewash),  (Easy iron),  (Water plus); reduced rinse and final spin cycle
Synthetics+	*-40 °C		Dark textiles made of cotton and dark easy-care textiles	(Intensive),  (Prewash),  (Easy iron),  (Water plus); no spin cycle between the rinse cycles
Silk	*-30 °C		For delicate, washable textiles, e.g. made of silk, satin, synthetic fibres or blended fabrics (e.g. curtains)	Especially gentle wash programme to prevent shrinkage, prolonged programme pauses (textiles rest in the detergent solution).
Wool	*-40 °C	2 kg	Hand or machine-washable wool or rich-wool textiles	(Intensive),  (Prewash),  (Easy iron),  (Water plus)
Sports Wash	*-40 °C		Textiles made of microfibres	Short programme approx. 15 minutes suitable for lightly soiled laundry
Super Quick	*-40 °C		Easy-care textiles made of cotton, linen, synthetic fibres or blended fabrics	

## Additional programmes

Rinse , Spin , Empty , Gentle Spin

**i** The programmes are time-controlled for lightly soiled textiles. If textiles are heavily soiled, select additional function (Intensive). When washing the maximum load for programmes marked with \*, always select the (Intensive) option. Regardless of the type of washing, **Synthetics 40 °C with maximum spin speed is the best short programme for the job.** Programmes without prewash – pour detergent into dispenser **II**, programmes with prewash – divide detergent between dispensers **I** and **II**.

Neff GmbH  
Carl-Wery-Str. 34  
81739 München / Germany

W732FOEU / ...

8808  
9000 249 350

## Consumption values

Programme	Additional function	Load	Current **	Water **	Programme duration **
Cottons  40 °C*	(Intensive)	7 kg	0.65 kWh	60 l	2:30 h
Eco  60 °C*	(Intensive)	7 kg	1.19 kWh	49 l	2:36 h
Cottons  90 °C	(Intensive)	7 kg	2.00 kWh	75 l	2:33 h
Synthetics  40 °C*	(Intensive)	3 kg	0.55 kWh	50 l	1:24 h
Synthetics  40 °C* (also suitable as <b>short programme</b> )	-	3 kg	0.54 kWh	40 l	0:55 h
Mix  30 °C	-	3 kg	0.32 kWh	35 l	0:44 h
Silk  30 °C	-	2 kg	0.25 kWh	38 l	0:32 h
Wool  30 °C*	-	2 kg	0.15 kWh	34 l	0:40 h

\* Programme setting to be tested in accordance with European standard 60 456.

Note on comparative tests: test the test programme with maximum load, (Intensive) option selected, maximum spin speed.  
A **short programme** which can be used for coloured items is **Synthetics 40 °C**, without the (Intensive) option selected and set to maximum spin speed.

\*\* The values deviate from the indicated values depending on water pressure, water hardness, water inlet temperature, room temperature, type and amount of washing and degree of soiling, utilised detergent, fluctuations in the mains voltage and selected additional functions.



## Safety instructions

- Read and follow the operating and installation instructions and all other information enclosed with the washing machine.
- Retain documents for subsequent use.

### Risk of electric shock

- Never pull out the mains plug by tugging the power cord!
- Never insert/pull out the mains plug with damp hands.

### Risk of injury

- Washing machine door may become very hot.
- Caution when draining hot detergent solution.
- Do not climb on the washing machine.
- Do not lean on the open washing machine door.
- Do not touch the drum in case it is still spinning.
- Caution when opening the detergent drawer while washing machine is running!

### Risk of poisoning

- Keep detergents and care products out of the reach of children.

### Risk of suffocation

- Keep packaging, plastic film and packaging parts out of the reach of children.

### Danger to life

- On redundant appliances:
- Pull out the mains plug.
  - Sever the power cord and discard together with the plug.
  - Destroy the lock on the washing machine door. This will prevent children from locking themselves in and suffocating.

### Risk of explosion

- Caused by detergents containing solvents, e.g. stain remover/items of washing pretreated with solvent naphtha may result in an explosion after being loaded into the washing machine. Beforehand thoroughly rinse items of washing by hand.

# Care



- Risk of electric shock! Pull out the mains plug!
- Risk of explosion! No solvents!

## Machine housing, control panel

- Wipe with a soft, damp cloth.
- Do not use any abrasive cloths, sponges or cleaning agents (stainless-steel cleaner).
- Immediately remove washing and cleaning agent residue.
- Do not clean the appliance with a water jet.

## Clean the detergent drawer ...

... if it contains detergent or fabric softener residue.

1. Pull out, depress insert, completely remove.
2. Open the cover.
3. Clean with water and dry.
4. Close and lock the cover (place cylinder on guide pin).
5. Insert detergent drawer.

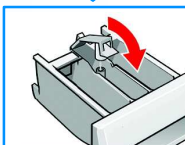
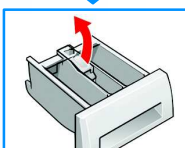
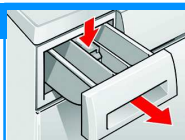

Leave detergent drawer open so that residual water can evaporate.

## Drum

Leave washing machine door open so that the drum can dry out.  
Rust stains – use chlorine-free cleaning agent, not steel wool.

## Descaling *No washing in the machine!*

Descale according to the instructions of the descaling agent-manufacturer, not required for correct detergent dosage.

# Information on the display panel *depending on model*

**F:16** Close the washing machine door properly; washing may be caught.

**F:17** Turn the tap on fully, supply hose kinked/jammed; clean filter -> page 10, water pressure too low.

**F:18** Filter blocked; clean detergent solution pump -> Page 10.  
Outlet pipe/drainage hose blocked; clean detergent solution pump -> Page 10.

**F:21** Motor fault. Call customer service!

**F:23** Water in the base pan, appliance leaking. Call customer service!

# Maintenance



- Risk of scalding! Allow detergent solution to cool down!
- Turn off the tap!

## Detergent-solution pump

Set programme selector to **Off**, pull out the mains plug.

1. Open and remove service flap.
2. For models with drainage hose: Take drainage hose out of the holder and pull out of the housing. Remove sealing cap, allow detergent solution to flow out. Press on sealing cap and insert drainage hose into the holder.
- For models without drainage hose:
- 2\* Carefully unscrew pump cover until the detergent solution begins to run out. When the service flap is half full, screw back the pump cover and empty the service flap. Repeat steps until all the detergent solution has run out.
3. Carefully unscrew the pump cover (residual water).
4. Clean the interior, pump cover thread and pump housing (fan impeller in the detergent-solution pump must rotate).
5. Reinsert and screw on pump cover.
6. Insert and close service flap.

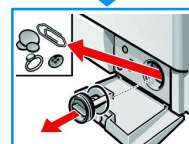
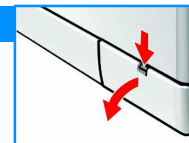

To prevent unused detergent from flowing into the outlet during the next wash: Pour 1 litre of water into dispenser II and select the **Empty** programme.

## Drainage hose on the siphon

Set programme selector to **Off**, pull out the mains plug.

1. Loosen hose clip, carefully remove drainage hose (residual water).
2. Clean drainage hose and siphon spigot.
3. Re-attach drainage hose and secure connection point with hose clip.



## Filters in the water supply



**Risk of electric shock!** Do not immerse Aqua-Stop safety device in water (contains electric valve).

Release water pressure in the supply hose:

1. Turn off the tap!
2. Select any programme (except **Spin** / **Empty**).
3. Press **Start/Pause**. Leave programme for approx. 40 seconds.
4. Set programme selector to **Off**.
5. Remove hose from tap.
6. Clean filter with small brush.
7. Depending on the model, remove hose from the rear of the appliance and clean the filter.

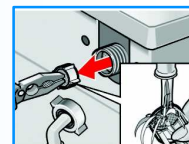

8. Connect the hose and check for leaks.

# What to do if ...

- Water is running out.
  - Correctly attach/replace drainage hose.
  - Tighten screw-fitting on the supply hose.
- Water not flowing in.  
Detergent not washed in.
  - **Start/Pause** ◊ not selected?
  - Tap not open?
  - Filter blocked? Clean filter → *page 10*.
  - Supply hose kinked or jammed?
- Washing machine door cannot be opened.
  - Safety function active. Wait approx. 2 minutes.
  - ☐ (Rinse hold = without final spin) selected?
- Programme does not start.
  - **Start/Pause** ◊ selected?
  - Door closed?
- Detergent solution is not drained.
  - Clean detergent-solution pump → *page 10*.
  - Clean outlet pipe and/or drainage hose.
- Washing not spun correctly.
  - Distribute small and large items of washing in the drum.
- Spin cycle actuated several times.
  - Not a fault – unbalanced load detection system adjusts imbalance.
- Water not visible in the drum.
  - Not a fault – water below the visible area.
- Residual water in the dispenser for care product.
  - Not a fault – effect of the care product not impaired.
- Odour formation in the washing machine.
  - Run **Cottons** 🌀🌀 90 °C programme without washing. Use standard detergent.
- Foam is coming out of the detergent drawer.
  - Too much detergent used?
  - If detergent comes out of the detergent drawer: mix 1 tablespoon of fabric softener with ½ litre of water and pour into dispenser II (*not for outdoor textiles!*).
  - Reduce detergent dosage for the next wash cycle.
- Vibrations during spin cycle.
  - Appliance feet fixed?  
Secure appliance feet → *Installation instructions*.
  - Transportation safety devices removed?  
Remove transportation safety devices → *Installation instructions*.
- Spin result not satisfactory.
  - ☐ (Easy iron) selected? → *page 5*.
- Display panel/indicator lights do not function while the appliance is running.
  - Power failure?
  - Fuse tripped? Switch on/replace fuse.
  - If the fault occurs repeatedly, call customer service.
- Programme progress longer than usual.
  - Not a fault – unbalanced load detection system adjusts imbalance by repeatedly distributing the washing.
  - Not a fault – Foam detection system active - a rinse cycle is started.
- Detergent residue on the washing.
  - Occasionally phosphate-free detergents contain water-insoluble residue.
  - Select **Rinse** ☐ or brush the laundry after washing.
- If a fault cannot be rectified or a repair is required:
  - Set programme selector to **Off** and pull out the mains plug.
  - Turn off the tap and call customer service → *Installation instructions*.

## OPERATING INSTRUCTIONS

en

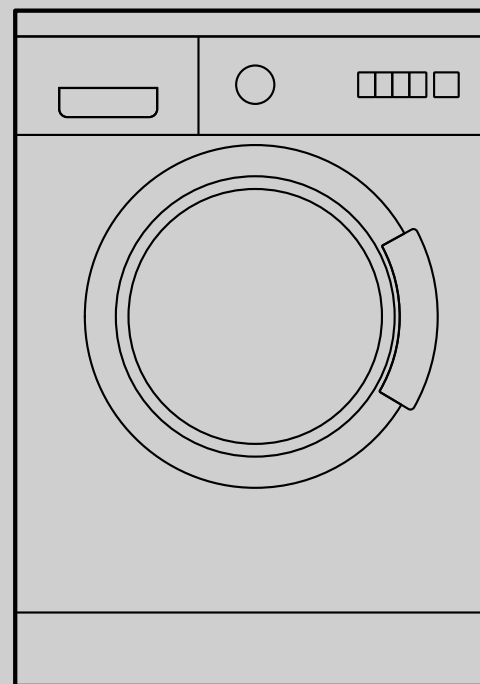

WASHING MACHINE



Read these instructions before switching on the washing machine!  
Also follow the separate Installation instructions.  
Follow the safety instructions on page 8!

