

**Installation instructions and
how to use and look after your
built-in cooker hoods
D99W3N0**

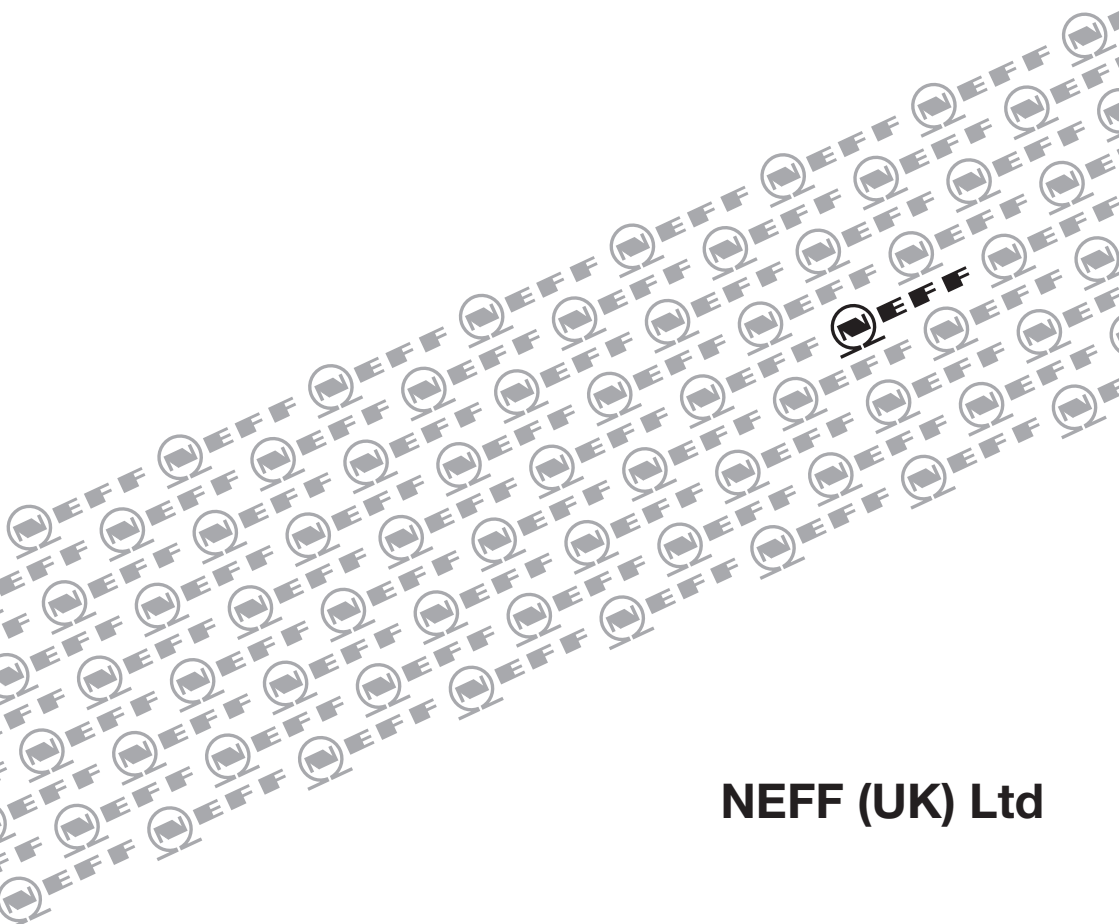

NEFF (UK) Ltd

Operating Instructions

Description of appliance

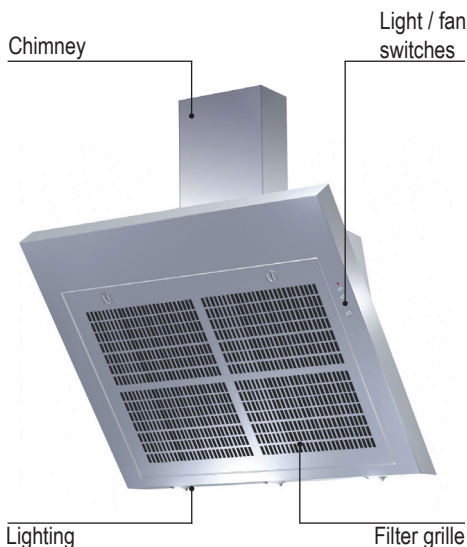

Operating modes

Exhaust-air mode:

- ☐ The extractor-hood fan extracts the kitchen vapours and conveys them through the grease filter into the atmosphere.
- ☐ The grease filter absorbs the solid particles in the kitchen vapours.
- ☐ The kitchen is kept almost free of grease and odours.

 **If the extractor hood is operated in exhaust-air mode at the same time as a flue-type heater (e.g. gas, oil or solid-fuel heater, instantaneous water heater, boiler), ensure that there is an adequate air supply** which the heater requires for combustion.

Safe operation is possible provided that the partial vacuum in the room in which the heater is installed does not exceed 4 Pa (0.04 mbar).

This can be achieved if the combustion air is able to flow through non-lockable openings, e.g. in doors, windows and in conjunction with an air supply/air-intake wall box or by other technical procedures such as reciprocal interlocking.

Operating modes



If the air intake is inadequate, there is a risk of poisoning from combustion gases which are drawn back into the room.

An air-intake/exhaust-air wall box by itself is no guarantee that the limiting value will not be exceeded.

Note: When assessing the overall requirement, the combined ventilation system for the entire household must be taken into consideration. This rule does not apply to the use of cooking appliances, such as hobs and ovens.

Unrestricted operation is possible if the extractor hood is used in recirculating mode – with activated carbon filter.

Circulating-air mode:

- ☐ An activated carbon filter must be fitted for this operating mode (see Filters and maintenance).
 -  The complete installation set and replacement filters can be obtained **from specialist outlets**.
- The corresponding accessory numbers can be found at the end of these operating instructions.
- ☐ The extractor-hood fan extracts the kitchen vapours which are purified in the grease filter and activated carbon filter and then conveyed back into the kitchen.
- ☐ The grease filter absorbs the grease particles in the kitchen vapours.
- ☐ The activated carbon filter binds the odorous substances.
-  If no activated carbon filter is installed, it is not possible to bind the odorous substances in the cooking vapours.

Before using for the first time

Important notes:

- ❑ The Instructions for Use apply to several versions of this appliance. Accordingly, you may find descriptions of individual features that do not apply to your specific appliance.
- ❑ This extractor hood complies with all relevant safety regulations.

Repairs should be carried out by qualified technicians only.

Improper repairs may put the user at considerable risk.

- ❑ Before using your appliance for the first time, please read these Instructions for Use carefully. They contain important information concerning your personal safety as well as on use and care of the appliance.
- ❑ Please retain the operating and installation instructions for a subsequent owner.
- ❑ This appliance is labelled in accordance with European Directive 2002/96/EG concerning used electrical and electronic appliances (waste electrical and electronic equipment – WEEE). The guideline determines the framework for the return and recycling of used appliances as applicable throughout the EU.



Gas hobs / gas cookers

⚠ Do not use all the gas hotplates simultaneously for a prolonged period (max. 15 minutes) at maximum thermal load, otherwise there is a risk of burns if the housing surfaces are touched or a risk of damage to the extractor hood. If the extractor hood is situated over a gas hob, operate the hood at maximum setting if three or more gas hotplates are operated simultaneously.

Safety instructions

⚠ Do not flambé food directly under the extractor hood.



Risk of grease filter catching fire due to flames.

⚠ The hotplates must always be covered with a utensil.

⚠ Restrictions apply to the use of the extractor hood over a solid-fuel burner (coal, wood, etc.). (See Installation instructions).

⚠ Do not use the appliance if damaged.

⚠ The appliance is not intended for use by young children or infirmed persons without supervision. Young children should be supervised to ensure they do not play with the appliance.

⚠ If the connecting cable for this appliance is damaged, the cable must be replaced by the manufacturer or his customer service or a similarly qualified person in order to prevent serious injury to the user.

⚠ The appliance may be connected to the mains by a qualified technician only.

⚠ Dispose of packaging materials properly (see Installation instructions).

⚠ This extractor hood is designed for domestic use only.

⚠ Light bulbs must always be fitted when the extractor hood is in use.

⚠ Defective bulbs should be replaced immediately to prevent the remaining bulbs from overloading.

⚠ Never operate the extractor hood without a grease filter.

⚠ Overheated fat or oil can easily catch fire.

If you are cooking with fat or oil, e.g. chips, etc., never leave the cooker unattended.

⚠ Carefully clean the extractor hood before switching on for the first time.

Operating the extractor hood

 The most effective method of removing vapours produced during cooking is to:

- ☐ **Switch the ventilator ON**
as soon as you begin cooking.
- ☐ **Switch the ventilator OFF**
a few minutes after you have finished cooking.

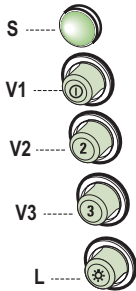

Key	Function
L Light	Switches the lighting system on and off.
S Led	Motor running led.
V1 Motor	Switches the extractor motor on and off at low speed. Used to provide a continuous and silent air change in the presence of light cooking vapours.
V2 Speed	Medium speed, suitable for most operating conditions given the optimum treated air flow/noise level ratio.
V3 Intensive	Maximum speed, used for eliminating the highest cooking vapour emission, including long periods.

Filters and maintenance

Grease filters:

Metal-mesh filters are used to trap the grease particles in the cooking vapours.

The filter mats are made from noncombustible metal.

Caution:

As the filter becomes more and more saturated with grease, there is an increased risk of fire and the function of the extractor hood may be impaired.

Important:

By cleaning the metal grease filters at appropriate intervals, the possibility of them catching fire as a result of a build-up of heat such as occurs when deep-fat frying or roasting is taking place, is reduced.

They are dishwasherable and need washing about every month or more frequently in case of a particularly intensive use.

Removing and inserting metal self-supporting grease filters

- ☐ First unhook the filter-holding Grid by acting on the special Handles.

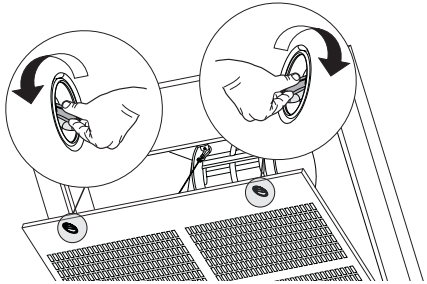

- ☐ Unhook the security chain by opening the shackle, then lift the grid upward.

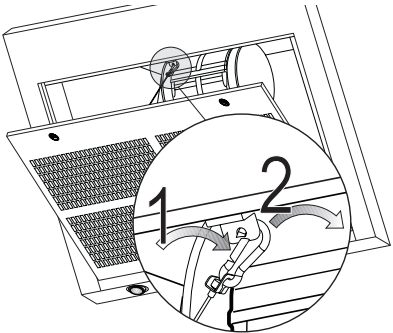

Filters and maintenance

- ☐ Remove the filters one by one.

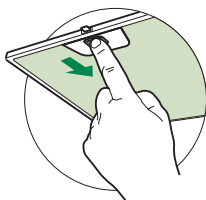

- ☐ Any kind of bending of the filters has to be avoided when washing them. Before fitting them again into the hood make sure that they are completely dry. (The colour of the filter surface may change throughout the time but this has no influence to the filter efficiency).
- ☐ Put the clean filters back on the Grid in its place
- ☐ Hook the security chain and put back the Grid onto the hood.

Filters and maintenance

Activated carbon filter:

For neutralizing odours in recirculating mode.

Caution:

As the filter becomes more and more saturated with grease, there is an increased risk of fire and the function of the hood may be impaired.

Important:

Change the activated carbon filter promptly to prevent the risk of fire from the accumulation of heat when deep-fat frying or roasting.

These filters are not washable and cannot be regenerated, and must be replaced approximately every year of operation, or more frequently with heavy usage.

Replacing the activated carbon filter

- ☐ Unhook the filter-holding Grid (see "Removing and inserting metal self-supporting grease filters")
- ☐ Remove the saturated activated carbon filter as shown (A).
- ☐ Fit the new filters (B). Filter can be ordered at the customer service

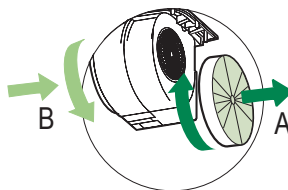

- ☐ Hook the filter-holding Grid (see "Removing and inserting metal self-supporting grease filters")

Disposal of the old activated carbon filter:

- ☐ Activated carbon filters do not contain any harmful substances. They can be disposed of as residual waste.

Cleaning and care

Isolate the extractor hood by pulling out the mains plug or switching off the fuse.

- ☐ When cleaning the grease filters, remove grease deposits from accessible parts of the housing. This prevents the risk of fire and ensures that the extractor hood continues operating at maximum efficiency.
 - ☐ Clean the extractor hood with a hot soap solution or a mild window cleaner.
 - ☐ Do not scrape off dried-on dirt but wipe off with a damp cloth.
 - ☐ Do not use scouring agents or abrasive sponges.
 - ☐ **Note:** Do not use alcohol (spirit) on plastic surfaces, as dull marks may appear.
- Caution:** Ensure that the kitchen is adequately ventilated. Avoid naked flames!

⚠ Clean the operating buttons with a mild soapy solution and a soft, damp cloth only. Do not use stainless-steel cleaner to clean the operating buttons.

Stainless steel surfaces:

- ☐ Use a mild non-abrasive stainless steel cleaner.
- ☐ Clean the surface in the same direction as it has been ground and polished.

⚠ Do not use any of the following to clean stainless steel surfaces: abrasive sponges, cleaning agents containing sand, soda, acid or chloride!

Aluminium and plastic surfaces:

- ☐ Use a soft, non-linting window cloth or micro-fibre cloth.
- ☐ Do not use dry cloths.
- ☐ Use a mild window cleaning agent.
- ☐ Do not use aggressive, acidic or caustic cleaners.
- ☐ Do not use abrasive agents.

Replacing the light bulbs

1. Switch off the extractor hood and pull out the mains plug or switch off the electricity supply at the fuse box.

⚠ When switched on, the halogen bulbs become very hot. Even for some time after the bulbs have been switched off there is still a risk of burns.

2. With the aid of a screwdriver pull out the bulbs or, if it is not easy, remove the 2 screws fixing the Lighting support, and pull it out of from the Hood.
3. Replace the halogen light bulb (conventional halogen bulb, 12 Volt, max. 20 Watt, GU4 bulbholder).

Caution: Plug-in bulbholder.

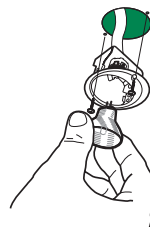

4. Replace the Support, fixing it in place with the two screws removed as above.
5. Restore the power by inserting the mains plug or switching on the fuse.

Note: If the light does not function, check that the bulbs have been inserted correctly.

If you encounter a problem

If you have any questions or if a fault occurs, please call Customer Service.

(See list of Customer Service representatives).

When you call, please quote the following:

E-Nr.	FD
--------------	-----------

Enter the relevant numbers into the box above. The E-Nr. (product no.) and FD (production date) are shown on the nameplate which can be seen inside the extractor hood after the filter frame has been detached.

⚠ The manufacturer of the extractor hoods accepts no liability for complaints which can be attributed to the design and layout of the pipework.

Installation Instructions:

Important information

⚠ Old appliances are not worthless rubbish. Valuable raw materials can be reclaimed by recycling old appliances. Before disposing of your old appliance, render it unusable.

⚠ You received your new appliance in a protective shipping carton. All packaging materials are environmentally friendly and recyclable. Please contribute to a better environment by disposing of packaging materials in an environmentally-friendly manner.

Please ask your dealer or inquire at your local authority about current means of disposal.

⚠ The extractor hood can be used in exhaust air or circulating air mode.

⚠ Always mount the extractor hood over the centre of the hob.

⚠ Minimum distance between electric hob and bottom edge of extractor hood: **400 mm**.

⚠ The extractor hood must not be installed over a solid fuel cooker – a potential fire hazard (e.g. flying sparks) – unless the cooker features a **closed, non-removable cover** and all national regulations are observed.

⚠ The smaller the gap between the extractor hood and hotplates, the greater the likelihood that droplets will form on the underside of the extractor hood.

Additional information concerning gas cookers:

⚠ When installing gas hotplates, comply with the relevant national statutory regulations (e.g. in Germany: Technische Regeln Gasinstallation TRGI).

⚠ Always comply with the currently valid regulations and installation instructions supplied by the gas appliance manufacturer.

⚠ Only one side of the extractor hood may be installed next to a high-sided unit or high wall. Gap at least 50 mm.

⚠ Minimum distance on gas hotplates between the upper edge of the trivet and lower edge of the extractor hood: **400 mm**.

Prior to installation

Exhaust-air mode

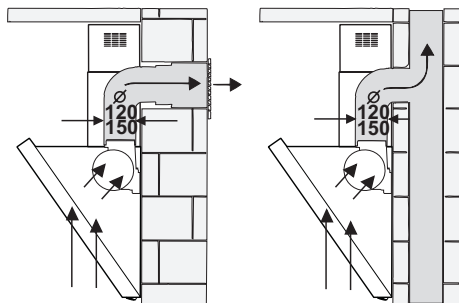

The exhaust air is discharged upwards through a ventilation shaft or directly through the outside wall into the open.

✋ Exhaust air should neither be directed into a smoke or exhaust flue that is currently used for other purposes, nor into a shaft that is used for ventilating rooms in which stoves or fireplaces are also located.

Exhaust air may be discharged in accordance with official and statutory regulations only (e.g. national building regulations).

Local authority regulations must be observed when discharging air into smoke or exhaust flues that are not otherwise in use.

When the extractor hood is operated in exhaust-air mode simultaneously with a different burner which also makes use of the same chimney (such as gas, oil or coal-fired heaters, continuous-flow heaters, hot-water boilers) care must be taken to **ensure that there is an adequate supply of fresh air** which will be needed by the burner for combustion.

Safe operation is possible provided that the under-pressure in the room where the burner is installed does not exceed 4 Pa (0.04 mbar).

This can be achieved if combustion air can flow through non-lockable openings, e.g. in doors, windows and via the airintake/ exhaust-air wall box or by other technical measures, such as reciprocal interlocking, etc.

If the air intake is inadequate, there is a risk of poisoning from combustion gases which are drawn back into the room.

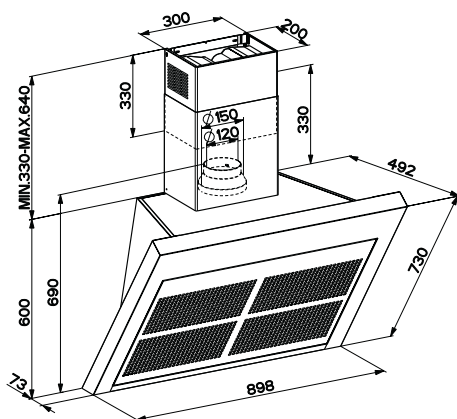

An air-intake/exhaust-air wall box by itself is no guarantee that the limiting value will not be exceeded.

Note: When assessing the overall requirement, the combined ventilation system for the entire household must be taken into consideration. This rule does not apply to the use of cooking appliances, such as hobs and ovens.

If the exhaust air is going to be discharged into the open, a telescopic wall box should be fitted into the outside wall.

For optimum extractor hood efficiency:

- ☐ Short, smooth air exhaust pipe.
- ☐ As few bends in the pipe as possible.
- ☐ Diameter of pipe to be as large as possible and no tight bends in pipe.

If long, rough exhaust-air pipes, many pipe bends or smaller pipe diameters are used, the air extraction rate will no longer be at an optimum level and there will be an increase in noise.

⚠ The manufacturer of the extractor hoods accepts no liability for complaints which can be attributed to the design and layout of the pipework.

Prior to installation

☐ Round pipes:

We recommend

Internal diameter: **150 mm** (at least 120 mm).

- ☐ **Flat ducts** must have an internal crosssection that equates to that of round pipes.

There should be no sharp bends.

Ø 120 mm approx. 113 cm²

Ø 150 mm approx. 177 cm²

- ☐ **If pipes have different diameters:** Insert sealing strip.

- ☐ **For exhaust-air mode,** ensure that there is an adequate supply of fresh air.

Connecting a Ø 150 mm exhaust-air pipe:

- ☐ Mount the pipe directly onto the air outlet on the hood.

Connecting a Ø 120 mm exhaust-air pipe:

- ☐ Attach the reducing connector directly to the air pipe.
- ☐ Attach the exhaust-air pipe to the reducing connector.

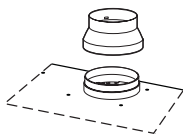

Circulating-air mode

- ☐ With activated carbon filter if exhaust-air mode is not possible.

⚠ The complete installation set can be obtained **from specialist** outlets. The corresponding accessory numbers can be found at the end of these operating instructions.

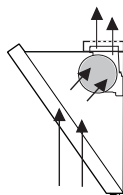
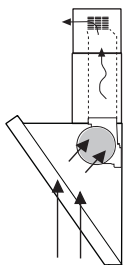

Preparing the wall

- ☐ The wall must be flat and perpendicular.
- ☐ Ensure that the wall is capable of providing a firm hold for mounting screws and plugs.

Weight in kg: 20.

We reserve the right to construction changes within the context of technical development.

Electrical connection

WARNING: THIS APPLIANCE MUST BE EARTHED

IMPORTANT: Fitting a Different Plug:

The wires in the mains lead are coloured in accordance with the following code:

Green and Yellow	– Earth
Blue	– Neutral
Brown	– Live

If you fit your own plug, the colours of these wires may not correspond with the identifying marks on the plug terminals.

This is what you have to do:

1. Connect the green and yellow (Earth) wire to the terminal in the plug marked 'E' or with the symbol (), or coloured green or green and yellow.
2. Connect the blue (Neutral) wire to the terminal in the plug marked 'N' or coloured black.
3. Connect the brown (Live) wire to the terminal marked 'L', or coloured red.

The extractor hood should only be connected to an earthed socket that has been installed according to relevant regulations.

If possible, site the earthed socket directly behind the chimney panelling.

- ☐ The earthed socket should be connected via its own circuit.
- ☐ If the earthed socket is no longer accessible following installation of the extractor hood, ensure that there is a permanently installed disconnector.

If it is necessary to wire the extractor hood directly into the mains:

The extractor hood should only be connected to the electricity supply by a properly qualified electrician.

A separator must be installed in the household circuit. A suitable separator is a switch that has a contact gap of more than 3 mm and interrupts all poles. Such devices include circuit breakers and contactors.

⚠ If the connecting cable for this appliance is damaged, the cable must be replaced by the manufacturer or his customer service or a similarly qualified person in order to prevent serious injury to the user.

Electrical connection

Electrical data:

Are to be found on the name plate inside the appliance after removal of the filterframe.

⚠ Before undertaking any repairs, always disconnect the extractor hood from the electricity supply.

Length of the connecting cable: 1.30 m.

This extractor hood corresponds to EC regulations concerning RF interference suppression.

Installation

This extractor hood is intended to be mounted onto the kitchen wall.

1. Unhook the filter-holding Grid (see "Removing and inserting metal self-supporting grease filters")
2. Draw a line on the wall from the ceiling to the lower edge of the hood at the centre of the location where the hood is going to be mounted.
3. Use the template or following the picture to mark the points (**A-B-C**) on the wall where the screws will be mounted.

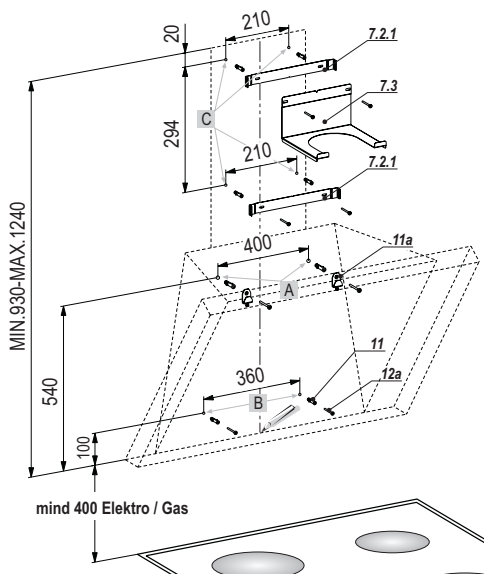

Note: Take into account any special accessories that are going to be fitted.

Installation

⚠ Ensure that the minimum distance between the hob and the extractor hood is maintained – **400 mm** for the electric or gas hob.

4. Drill \varnothing 12 mm holes **A** and \varnothing 8 mm holes **B** for the extractor hood. Drill \varnothing 8 mm holes **C** for the chimney brackets (only if you think to install the chimney).
5. Insert bracket plugs **11a** into the holes **A** and screw into place.
6. Insert plugs **11** into the holes **B** and **C** so that they are flush with the wall.
7. Fix the brackets **7.2.1** using the **12a** screws supplied (only if you think to install the chimney).

⚠ In case of hood installation in recirculation version with the chimney, the upper bracket **7.2.1** must be fixed together with the Air Outlet Connection Support **7.3**.

Mounting the hood body

8. Adjust the two screws **Vr**, on brackets **11a**, to a minimum.
9. Hook the hood canopy onto the two brackets **11a**.
10. From inside the hood canopy, adjust the screws **Vr** to set the Hood Canopy level.

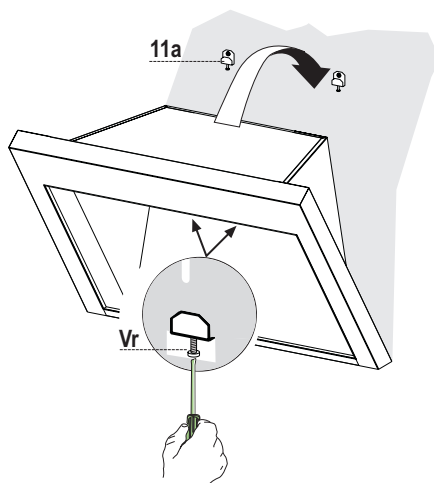

11. Tighten the safety screw **11** in holes **B**.

Installation

Connection in Ducting Version

When installing the ducting version, connect the hood to the chimney using either a flexible or rigid pipe \varnothing 150 or 120 mm, the choice of which is left to the installer.

- ❑ To install a \varnothing 120 mm air exhaust connection, insert the reducer flange **9** on the hood body outlet.

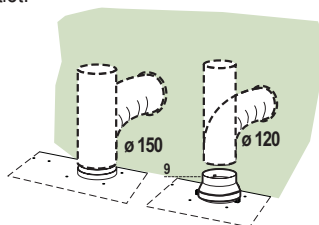

- ❑ Fix the pipe in position using sufficient pipe clamps (not supplied).
- ❑ Remove charcoal filters, if present.

Connection in Recirculation Version

without chimney:

⚠ For the recirculation version without chimney, only the charcoal is additionally required. Please call customer service to order the charcoal filter.

- ❑ Screw the filter cover **16** onto the air outlet, using four screws **12c** supplied.
- ❑ Fix the directional grille **8** on the filter cover air outlet using the 2 screws **12d** provided.

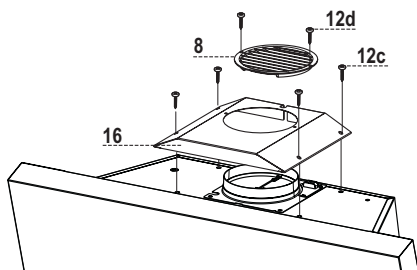

- ❑ Ensure that the activated charcoal filters have been inserted. (see parag. "Activated carbon filter" in Filters and Maintenance chapter)

with chimney:

⚠ All the items named in this procedure are included in the recirculation kit. The corresponding accessory numbers can be found at the end of these operating instructions.

- ❑ Put connection **15** into the connection support **7.3**.
- ❑ Insert the connection extension pieces laterally **14.1** in connection **15**.
- ❑ Make sure that the outlet of the extension pieces **14.1** is horizontally and vertically aligned with the chimney outlets.
- ❑ Connect the air outlet connection **15** to the hood body outlet using either a pipe \varnothing 150 mm.

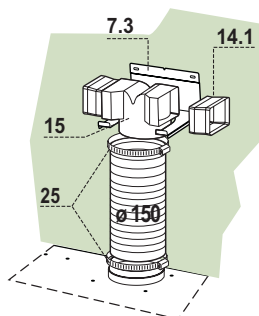

- ❑ Use the jubilee clips **25** to ensure a fix connection between pipe and hood outlet and between pipe and connection (**15**).
- ❑ Ensure that the activated charcoal filters have been inserted. (see parag. "Activated carbon filter" in Filters and Maintenance chapter)

Chimney assembly

⚠ The chimney cannot be installed in recirculation hood with the filter cover.

- ❑ Fasten the angle iron **15** to the hood canopy using the screws **12d** provided.

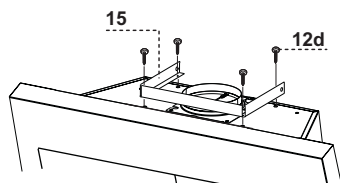

Upper Chimney

- ❑ Slightly widen the two sides of the upper Chimney and hook them behind the brackets **7.2.1**, making sure that they are well seated.
- ❑ Secure the sides to the brackets using the 4 screws **12c** supplied.
- ❑ Make sure that the outlet of the extensions pieces is aligned with the chimney outlets.

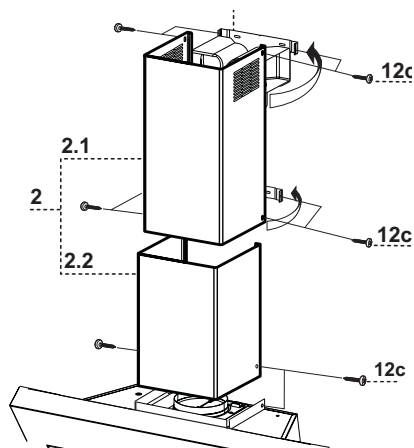

Lower Chimney

- ❑ Slightly widen the two sides of the Chimney and hook them between the upper Chimney and the wall, making sure that they are well seated.
- ❑ Fix the lower part laterally to the hood body using the 2 screws **12c** supplied.

Notes

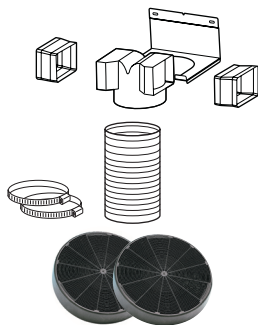

Z5126X5

NEFF (UK) Ltd.
Grand Union House,
Old Wolverton Road,
Old Wolverton
Milton Keynes, MK12 5PT
Tel: 01908 328300
Fax: 01908 328399

436003841_02 - 070824
Printed in Italy