

*N 50, BUILT-IN OVEN WITH ADDED STEAM  
FUNCTION, 60 X 60 CM, GRAPHITE-GREY  
B5AVM7AG0A*

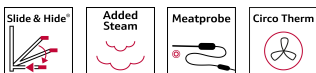

Z11AB15A0 Baking tray, non-stick ceramic coated, Z11AU15A0 Universal pan, non-stick ceramic coated, Z11CR10X0 Baking and roasting grid (standard), Z11GU20X0 Glasspan, Z11TI15X0 Cliprails, Z12CB10A0 Baking tray, enamelled, Z12CL10A0 Lid for professional pan, enamelled, Z12CN10A0 Professional pan, enamelled, Z12CP10A0 Pizza pan, enamelled, Z12CU10A0 Multipurpose pan, enamelled, Z1365WX0 Wireless food thermometer, Z13CR10X0 Baking and roasting grid (steam), Z13CV05S0 Cover Strip, Z1608BX0 Full ext rails, level independent, Z1650BE0 Half tray, Z1655CA0 Air Fry & Grill tray, Z1913X0 Baking Stone, Z19DD10X0 Steam set for ovens, Z99RX70X0 Connecting cable 3m

Built-in oven with AddedSteam and Slide&Hide® - for excellent cooking results and greater access to the oven interior

- ✓ Slide&Hide® – The unique fully disappearing oven door.
- ✓ Added Steam – a simple push for the right amount of steam to make your food juicy on the inside and crispy on the outside
- ✓ LCD-Display – simple, straightforward with large characters for clear reading
- ✓ Singlepoint Meatprobe – keeps one eye constantly on the oven temperature
- ✓ CircoTherm® – The smart hot-air function lets you bake on up to three levels at once and achieve even cooking results.

Color / Material Front: ..... Graphite-Grey  
Built-in / Free-standing: ..... Built-in  
Door opening: ..... Drop down  
Cleaning : ..... Pyrolytic+Hydrolytic  
Control Panel Material: ..... Glass  
Door Material: ..... Glass  
Dimensions (HxWxD): ..... 595x594x548 mm  
Dimensions of the packed product (HxWxD): . 675 x 660 x 690 mm  
Required niche size for installation (HxWxD): 585-595 x 560-568 x 550 mm  
Cavity dimensions: ..... 357 x 480 x 415 mm  
Usable volume of cavity: ..... 71 l  
Number of interior lights: ..... 1  
Net weight: ..... 41.8 kg  
Gross weight: ..... 44.4 kg  
EAN code: ..... 4242004272168  
Connection Rating: ..... 3600 W  
Fuse protection: ..... 16 A  
Voltage: ..... 220-240 V  
Frequency: ..... 50; 60 Hz  
Length electrical supply cord: ..... 120.0 cm



*N 50, BUILT-IN OVEN WITH ADDED STEAM  
FUNCTION, 60 X 60 CM, GRAPHITE-GREY  
B5AVM7AG0A*

#### Heating Functions

- 8 heating methods: CircoTherm®, Top/bottom heating, Circo-roasting, Full surface grill, Pizza Setting, Bread Baking, CircoTherm® gentle, Reheating
- Heating modes combinable with steam function: CircoTherm® + steam, Circo-roasting + steam, Top/bottom heat + steam
- Temperature range 30 °C - 275 °C
- Cavity volume: 71 net usable litres

#### Racks and Rails

- Number of shelf levels: 4
- Large capacity oven with shelf supports, Telescopic shelf rails available as optional accessory

#### Design

- Graphite-Grey Edition
- Rotary Control, Retractable control knobs
- Cavity inner surface: enamel

#### Cleaning

- Pyrolytic self cleaning
- EasyClean® program
- Full glass inner door - safer touch door

#### Convenience

- White LCD display
- Electronic clock with start / stop function
- Automatic temperature proposal, automatic start, Actual temperature display, Optical temperature control, Meat probe function
- Number of automatic programmes: 15
- Additional functions: Descaling program
- Hide®, the fully retracting oven door
- Slide®, the revolving handle
- Automatic programs
- Single-point meat probe
- Rapid heat-up
- Halogen lighting
- Water tank with 200 ml capacity
- Location of the steam generator is outside of the cavity
- Cooling fan
- Stainless-steel fan
- Info button
- HomeConnect

#### Accessories

- 1 x combination grid, 1 x universal pan

#### Safety Features

- Maximum door temperature 30° C
- Quadruple glazed CoolTouch door
- Automatic door lock during pyrolysis, Individual adjustable child lock, Safety switch off, Residual heat indicator, Door contact switch

#### Technical Information

- Length of mains cable: 120 cm
- Nominal voltage: 220 - 240 V
- Total connected load electric: 3.6 KW
- Energy efficiency rating (acc. EU Nr. 65/2014): A(at a range of energy efficiency classes from A+++ to D)
- Energy consumption per cycle in conventional mode:1.04 kWh
- Energy consumption per cycle in fan-forced convection mode:0.81 kWh
- Number of cavities: 1 Heat source: electrical Cavity volume:71 net usable litres

#### Dimensions

- Appliance dimensions (HxWxD): 595 mm x 594 mm x 548 mm
- Installation dimensions (HxWxD): 585 mm - 595 mm x 560 mm - 568 mm x 550 mm
- Please reference the built-in dimensions provided in the installation drawing
- We recommend you to choose complementary products within N50, in order to assure an optimal design combination of your Built-In appliances.

N 50, BUILT-IN OVEN WITH ADDED STEAM  
FUNCTION, 60 X 60 CM, GRAPHITE-GREY  
B5AVM7AG0A

Measurements in mm

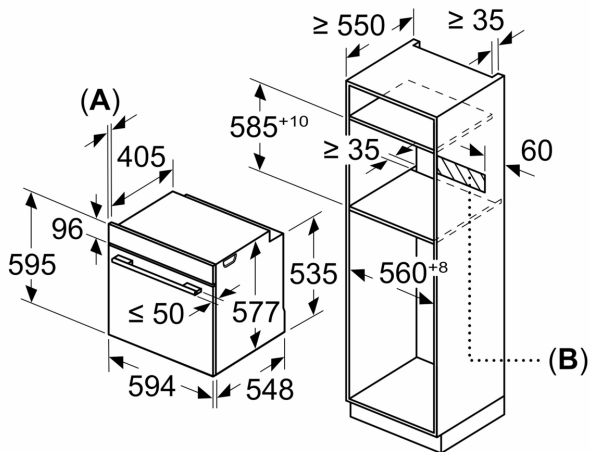

**A:** 19.5 mm

**B:** Space for appliance connection 320 x 115 mm

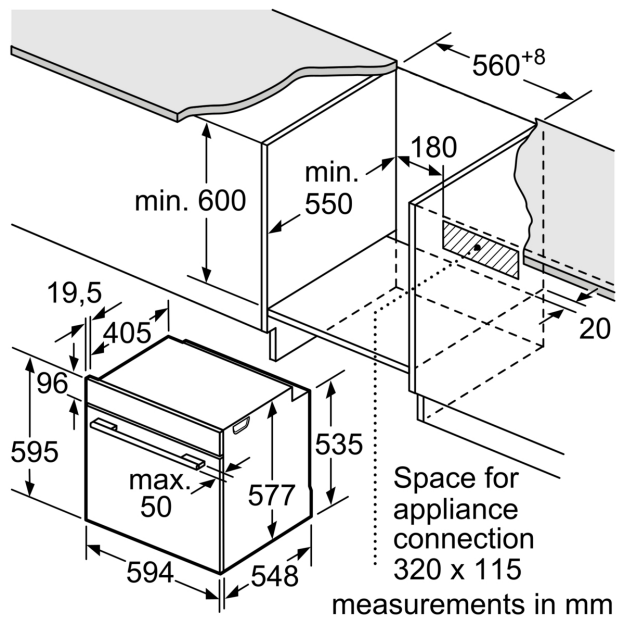

measurements in mm

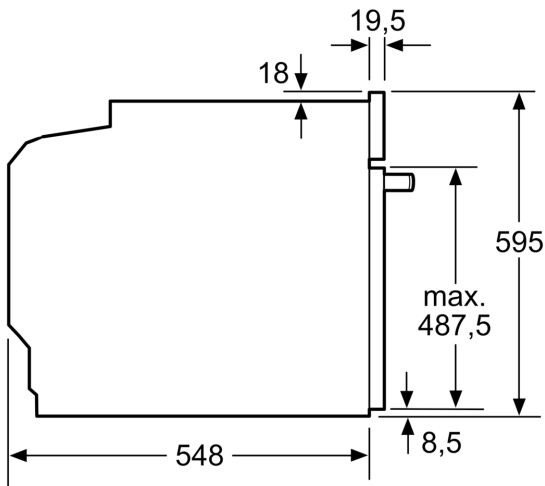

measurements in mm

Installation with a hob.

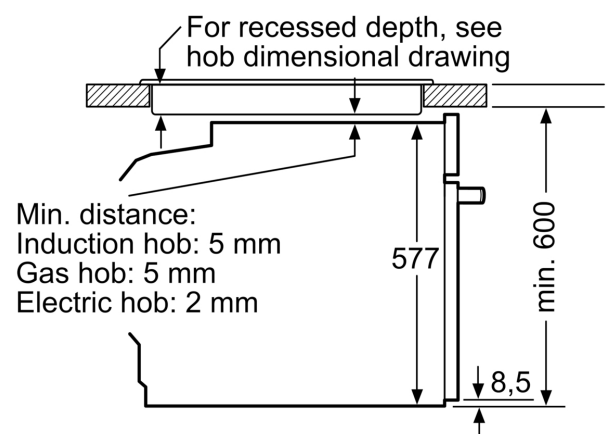

measurements in mm