

N 50, BUILT-IN OVEN, 60 X 60 CM, STAINLESS
STEEL
B5ACM7H40B

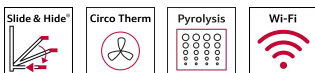

Built-in oven with Slide&Hide® - unrestricted access to the oven interior

- ✓ Slide&Hide® – The fully disappearing oven door with rotating handle.
- ✓ CircoTherm® – Smart hot-air solution that lets you bake on up to three levels at once.
- ✓ Dual cleaning options: Pyrolytic cleaning programmes - just let the oven interior clean itself. EasyClean - the quick and easy option for day to day maintenance.
- ✓ LCD-Display – simple, straightforward with large characters for clear reading
- ✓ Home Connect – Unleash your creativity via app.

Features

Technical Data

Built-in / Free-standing: Built-in
Integrated Cleaning system: Pyrolytic+Hydrolytic
Required niche size for installation (HxWxD): 585-595 x 560-568 x 550 mm
Dimensions: 595x594x548 mm
Dimensions of the packed product (HxWxD): . 675 x 660 x 690 mm
Control Panel Material: Glass
Door Material: Glass
Net weight: 35.6 kg
Usable volume (of cavity) - cavity 1: 71 l
Cooking method: Bread Baking Setting, Full width grill, Hotair gentle, Hot Air, Conventional heat, Pizza setting, Bottom heat, Hot air grilling
First cavity material: Other
Oven control: electronic
Length electrical supply cord: 120.0 cm
EAN code: 4242004245810
Number of cavities (2010/30/EC): 1
Energy efficiency rating: A
Energy consumption per cycle conventional (2010/30/EC): 1.04 kWh/cycle
Energy consumption per cycle forced air convection (2010/30/EC): 0.81 kWh/cycle
Energy efficiency index (2010/30/EC): 95.3 %
Connection Rating: 2990 W
Fuse protection: 13 A
Voltage: 220-240 V
Frequency: 50; 60 Hz
Plug type: no plug (electrical connection by electrician)
Included accessories: 1 x combination grid, 1 x universal pan

Included accessories

1 x combination grid, 1 x universal pan

Optional accessories

Z11AB15A0 Baking tray, non-stick ceramic coated, Z11AU15A0 Universal pan, non-stick ceramic coated, Z11CB10E0 Baking tray, enamelled, Z11CR10X0 Baking and roasting grid (standard), Z11CU10E0 Multipurpose pan, enamelled, Z11GT10X3 Glass roasting dish, 5,4l, Z11TE25X0 2 level telescopic shelf rails, Z11TF25X0 2 level telescopic shelf rails,full ext, Z11TF36X0 3 level telescopic rails, full ext, Z11TI15X0 Cliprails, Z11TJ25X0 2 level telescopic rails incl 1VarioClip, Z11TJ35X0 3 level telescopic rails incl 1VarioClip, Z1352X0 Pizza pan, enamelled, Z13CR10X0 Baking and roasting grid (steam), Z13CV05S0 Cover Strip, Z1913X0 Baking Stone, Z19DD10X0 Steam set for ovens



4 242004 245810

N 50, BUILT-IN OVEN, 60 X 60 CM, STAINLESS
STEEL
B5ACM7HH0B

Features

Design

- LCD-Display Control (white)
- Bevelled oval controls, Retractable controls dials, oval
- Slide&Hide® with rotating handle
- Cavity inner surface: enamel grey
- 4 shelf positions

Features

- HomeConnect ready on WLAN
- Door lock during pyrolytic cleaning
- Control panel lock Automatic safety switch off Residual heat indicator Door contact switch
- Temperature proposal
- Actual temperature display Heating up indicator Automatic start meat probe
- Single-point meat probe
- Interior halogen light, On/off button

Cleaning

- Pyrolytic cleaning
- EasyClean
- Full glass inner door

Programmes/functions

- Oven with 8 cooking functions: heating methods: CircoTherm®, Top/bottom heat, Circo-roasting, Full surface grill, CircoTherm® intensive, Bread baking, Bottom heat, CircoTherm® gentle
- Rapid heat
- Cooling fan

Accessories

- 1 Clip rail, Stop function
- 1 x combination grid, 1 x universal pan

Performance/technical information

- Energy efficiency rating (acc. EU Nr. 65/2014): A
- Energy consumption per cycle in conventional mode: 1.04 kWh
- Energy consumption per cycle in fan-forced convection mode: 0.81 kWh
- Number of cavities: Main cavity Heat source: electrical Cavity volume: 71 litre
- Total connected load electric: 2.99 KW
- 120 cm Cable length
- Nominal voltage: 220 - 240 V
- Appliance dimension (h x w x d): 595 mm x 594 mm x 548 mm
- Niche dimension (h x w x d): 585 mm - 595 mm x 560 mm - 568 mm x 550 mm
- Please refer to the dimensions provided in the installation manual

N 50, BUILT-IN OVEN, 60 X 60 CM, STAINLESS
STEEL
B5ACM7HH0B

Dimensioned drawings

If the appliance will be installed underneath a hob, the following worktop thicknesses (including substructure if necessary) must be taken into account.

Hob type	min. worktop thickness	
	fitted	flush
Induction hob	37 mm	38 mm
Full surface Induction hob	47 mm	48 mm
Gas hob	30 mm	38 mm
Electric hob	27 mm	30 mm

Measurements in mm

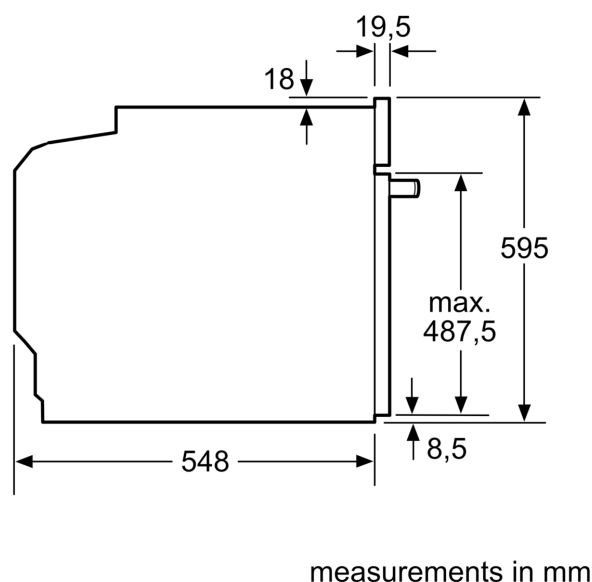
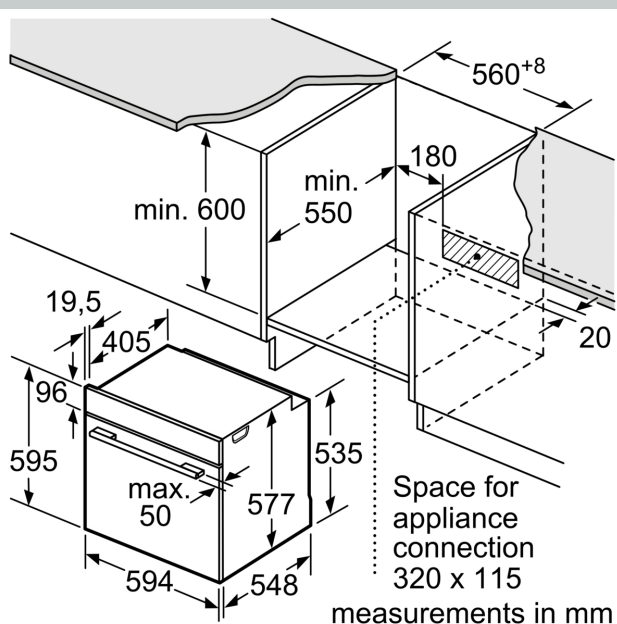
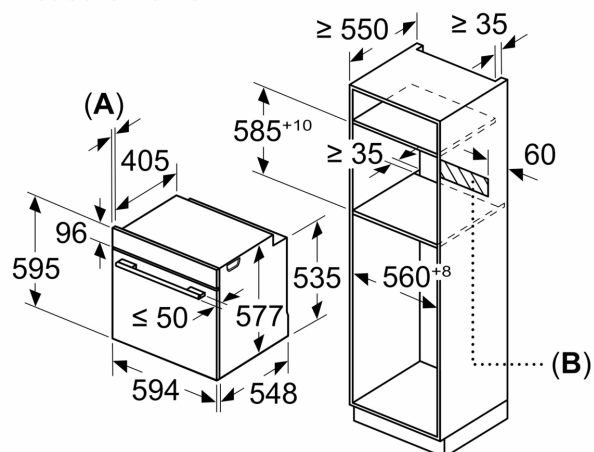

Dimensioned drawings

Installation with a hob.

